

# **SOLDIER'S INVESTIGATION GUIDE and CRIME TIP MANUAL**

**MNFI/CCCI**

**U.S. Embassy Baghdad, Iraq**

**Investigators: DSN: (318) 239-8497**

**Attorneys: DSN: (318) 239-8489**

**Translators: DSN (318) 239-8486**



**Prepared by:**  
**Matt Coakley, Capt, USAF**  
**&**  
**John Hicks, MAC(SW), USN**

**Production Editor:**  
**Karl A. Allen II**

# TABLE OF CONTENTS

Evidentiary Necessities	Page 3
- Evidence Handling Procedures	Page 3
- Photographs	Page 4
- Statements	Page 4
- Diagrams	Page 6
Other Important Points	Page 7
- What to Seize and Do on the objective	Page 7
- Dealing with Money	Page 7
- Determining the Detainee's Identity	Page 8
Crime Categories Checklist	Page 9
- Weapons Cache Inside Residences	Page 9
- Weapons Cache Outside Residences	Page 9
- Weapons Inside Vehicles	Page 10
- VBIEDs and IEDs Involving Vehicles	Page 10
- VBIEDs and IEDs Which Result in Injuries and/or Death to Coalition Forces	Page 11
- Unexploded IEDs	Page 11
- Drive by Shootings	Page 11
- Attacks and Assaults against CF Personnel	Page 12
- Propaganda	Page 12
- Kidnapping	Page 12
- Escapes	Page 13
- Harboring Fugitives, Third Country Nationals, or Foreign Fighters	Page 13
Appendix A – Evidence Handling	
- TF 134 Recommended List of Useful Items	Page A-1
- Proper Evidence Handling Procedures	Page A-2
Appendix B – Sample Forms and Diagrams	
- Sworn Statement	Page B-1
- Coalition Provisional Authority Forces Apprehension Form	Page B-2/3
- Evidence/Property Custody Document	Page B-4
- Evidence Inventory Form	Page B-5
- Diagrams	Page B-6/7
Appendix C – Sample Photographs	
- Weapons Inside Residence	Page C-1/2
- Weapons Outside Residence	Page C-3
- Weapons Inside Vehicles	Page C-4
- VBIED & IED Involving Vehicles	Page C-5
- Unexploded VBIED or IED	Page C-6
- Drive By Shooting	Page C-7
- Attacks & Assaults Against CF Personnel	Page C-7
- Propaganda	Page C-8
- Do's and Don'ts of Photography	Page C-9/10

# INTRODUCTION

- We understand that your first mission is military operations, **NOT** law enforcement.
- Our job is to work within the judicial system and understand its needs and update units on emerging trends in the judicial system.
- This useful checklist will help Coalition Forces (CF) personnel obtain and properly document evidence and all other documentation that is needed to prosecute detainees before the Central Criminal Court of Iraq (CCCI).

## EVIDENTIARY NECESSITIES

There are three types of evidence that are necessary to ensure a successful CCCI prosecution: **Photographs**, **Sworn statements**, and **Diagrams**. This is normally referred to as the acronym **PSD**.

- **P – Photographs**

Take as many photographs as you can, of as much as you can. The pictures are used to show the judges what happened and where it happened and will aid the witnesses when testifying. Remember, a picture is worth a thousand words.

- **S – Sworn statements/witness testimony**

Be as thorough and detailed as possible. The statement needs to contain the five **Ws** (**Who**, **What**, **When**, **Where**, **Why**) and **How**.

- **D – Diagrams**

Draw a detailed diagram of the crime scene. This could be a house, field or vehicle.

## EVIDENCE HANDLING PRODEDURES

We understand that you are combat units in the field conducting combat operations, not trained law enforcement investigators. However, the more evidence you collect on the objective the more chance the detainees will be detained for extended periods. The amount of evidence you collect determines, more than anything else, if the detainee will be sent to Central Criminal Court of Iraq (CCCI) where if convicted they face up to 20 years imprisonment or to the Combined Review and Release Board (CRRB) where they are eligible for release in six months or less. With that in mind, you should take reasonable steps when collecting evidence in the field that will not compromise your safety. Photographing everything will shorten your time on the objective because it allows you to process things later. Minimize the handling of items or weapons that could be fingered printed or forensically analyzed or identifying which items were found in a certain detainee's home or on the person of a specific detainee. Photograph the detainee at the objective with the evidence, if possible, especially with the weapons, explosives or contraband found. Place the

evidence found in separate vehicles or containers that is seized on the objective, so that it can be easily sorted out later. The proper chain of custody documents and proper storage care of items seized can be done when you have returned to the safety of your Forward Operating Base (FOB). Use the photographs of the scene to refresh your memory when filling out the evidence tags and the witness statements back at the FOB. Remember, though, the more pictures you take on the objective the better. However, if the FOB is the only place that pictures can be safely taken, then take the photographs back at the FOB. In Appendix A-2 we have provided you with the proper procedures for handling evidence, use these procedures when you are back at the FOB. The bottom-line, if it relates to the reason why you are detaining the individual then seize it or photograph it, if safely possible.

## PHOTOGRAPHS

- Photograph anything that may be considered evidence (weapons, ammunition, money, detonators, etc.).
- Make sure to take a photograph of detainees with the evidence—**THIS IS A MUST!**
- Photographs need to establish the location of the crime scene by including landmarks and/or reference points.
- If ever in doubt, **PHOTOGRAPH IT**; more is better than less.
- Make sure to include date, time, and location when photographs were taken.
- If you have a digital camera, set it up so the pictures will have the date and time on them. (*Note: Make sure it is the correct date and time because if you have the wrong date and time it hurts the case and you may have to explain why the capture date is different.*)
- **TAKE PHOTOGRAPHS AS SAFELY AS POSSIBLE – ABOVE ALL, SAFETY COMES FIRST!**

## STATEMENTS

### WITNESS STATEMENTS

- Important: In order to be a witness, you must actually have been there.
- Statements should be **SPECIFIC** and answer the **WHO, WHAT, WHEN, WHERE, WHY** and **HOW**.

#### **Who:**

- (1) List the names of all the detainees captured and their respective capture tag numbers.
- (2) List at least five soldiers who actually witnessed the event or actively participated in the raid, if possible.

**What, How and Why:**

- (1) Describe how the events leading to the detainees' capture occurred.
- (2) Explain what happened. (For example: The detainees shot at Coalition Forces or a weapons cache was found in the detainee's home.)
- (3) If known, state why the events occurred. Did the detainees admit why they acted or what their motives were?

**When and Where:**

- (1) Record the date and time.
  - (2) Note the nearest town and province and the street name in the town. Be specific. Do not just use the grid coordinates. The judges don't understand the grid coordinates. (For example: On 23 November 2005, at approximately 0400 hours, near the city of Al' Fullajah, which is located in Al' Anbar province...)
- Make sure to get statements from at least three **CF WITNESSES**, if possible. Don't confuse this with the listing of five soldiers in the **WHO** above. Also get a statement from the detainee if he or she is willing to provide a statement.
  - Written statements should be obtained from the witnesses as soon as possible while the facts and circumstances are still fresh in their memories.
  - Statements should include a question and answer after the narrative if all of the Who, What, When, Where, Why and How have **NOT** been answered.
  - All statements need to be closed out and signed by the witness and/or detainee.
  - Remember to print on the forms and to take the time to write legibly. A lot of different people will be relying on that statement in the future.
  - Remember to take your time and address the details of the event in your statement so that the people reading your statement will have a better understanding of what happened.
  - Remember to list all the detainees captured by name and capture tag. For example if there are two target houses make sure you explain which detainees were captured in which target house.
  - Refer to the example in Appendix B, page B-1.

**APPREHENSION FORM**

- Correct contact information for the unit **IS A MUST!** Providing the following:
- Contact information for all witnesses.
- Capture tag numbers, dates, grids, name of closest town or city, name of province, and any other pertinent information on the detainee.
- Disposition and location of all detainees being transferred.

- When the unit will be redeploying and new contact information.
- Refer to example in Appendix B, page B-2 and B-3.

### **EVIDENCE/PROPERTY CUSTODY DOCUMENT (DA FORM 4137)**

- All blocks must be filled out – NO EXCEPTIONS!
- Be specific when describing the evidence: include model, serial numbers and any other identifying marks.
- Maintain a proper chain of custody. Everyone who handles the evidence must be listed on the DA Form 4137.
- The person who collected the evidence should be the first name in the “Released by” block on the form.
- Use only block style lettering, except in the signature block.
- Refer to the example in Appendix B, page B-4.

### **EVIDENCE INVENTORY FORM**

- The Arabic/English Inventory Document should indicate exactly what has been seized from each detainee’s vehicle/house/property/person AND contain a section for the detainee’s acknowledging signature OR refusal to sign.
- Units should complete the inventory document as soon as possible and have the detainee sign immediately, preferably at the scene. Get photographs of detainee signing the document, if possible.
- Refer to the example in Appendix B, page B-5.

## **DIAGRAMS**

### **DIAGRAMS/SKETCHES**

- Reference where the detainees were found in relation to the crime scene.
- Reference landmarks, cities, villages, and key points of interest.
- Show where the evidence was found.
- Estimate distances in meters.
- Diagram should support your photographs.

- The diagram or sketch can be hand drawn.
- Use simple words and phrases, for example “road” instead of “MS Tampa.”
- This is your chance to show the Investigative Hearing Judge what happened.
- Refer to the example in Appendix B, page B-6 and B-7.

## **OTHER IMPORTANT POINTS**

### **WHAT TO SEIZE AND DO ON THE OBJECTIVE**

- Seize all weapons, computers, cell phones, money and documents. Remember to take all forms of identification, for example ID cards, passports, etc.
  - Secure the material in a sealed container (e.g., a plastic bag) marked with the date, time, name, rank, and unit of the person who seized it.
  - Handle all material in a forensically correct manner. (e.g., minimal handling, with gloves, by the edges.)
- All explosives should be destroyed by EOD.
- Remember to photograph the detainee with the evidence seized. Photographs of the detainee with the evidence on the objective is preferred, but they can be taken at the FOB.
- Remember to conduct explosive testing on the detainees. The testing may be conducted on or off the objective. Photograph the testing, if possible.
- Vapor Trace is the preferred method of explosive testing by the Iraqi Court System and by the Combined Review and Release Board.

## **DEALING WITH MONEY**

- Money keeps the insurgents in business.
- Take away the money and you take away most insurgent activity.
- Seize and bag ALL cash, checks, check books, money ledgers, pocket litter, and all sensitive items. The non-currency items (money ledgers or bank books) may help the S-2 shop find out how the insurgents obtain their weapons or explosives, in other words what looks like trash to you may be solid gold to the intelligence folks.
- Make sure you accurately document and account for the currency you recover. For example if you find a lot of United States currency you should write down the serial numbers. However, there is no need to do this for Iraqi currency, but remember to photograph it.

## DETERMINING THE DETAINEE'S IDENTITY

Remember to seize all identification cards and passports. These documents will be used to determine the individual's identity at trial and whether or not the individual is a juvenile. You also need to take close up photographs of both the front and back of these documents in case the ones you seized are lost.





# CRIME CATEGORIES CHECKLISTS

## WEAPONS CACHE INSIDE RESIDENCES

- \_\_\_\_\_ If the weapons are hidden, photograph them in the hiding place before removing them or if in boxes/containers make sure the lid is open so that the picture shows what is inside the container or box.
- \_\_\_\_\_ Photograph the room and/or area where the weapons or contraband were found.
- \_\_\_\_\_ Photograph of each detainee and the weapons together. (*Note: this picture is referred to as the money shot and is a must!*)
- \_\_\_\_\_ If more than one detainee, also take a picture of all the detainees together with the cache.
- \_\_\_\_\_ Take close ups of the weapons, grenades, det cord, RPGs, ammunition, etc....
- \_\_\_\_\_ Take a photograph of the exterior of the detainee's house. (*Note: courtyard, walls, entrance and exit points and any major landmarks.*)
- \_\_\_\_\_ Take a photograph of the family members in front of their residence. (*Note: this is used in case the detainee denies ownership of the house.*)
- \_\_\_\_\_ List all weapons and contraband found on the appropriate forms, i.e., the evidence/property inventory form, witness statements, and apprehension form.
- \_\_\_\_\_ The witness statements should state how many photographs were taken and who took them.
- \_\_\_\_\_ Remember to include the photographs in the file.  
**(Example pictures are found in Appendix C, page C-1)**

## WEAPONS CACHE OUTSIDE RESIDENCES

- \_\_\_\_\_ If the weapons are hidden, photograph them in the hiding place before removing them or if in boxes/containers make sure the lid is open so that the picture shows what is inside the container or box.
- \_\_\_\_\_ Take a photo of each detainee and the weapons found. (*Note: this is the money shot and is a must!*)
- \_\_\_\_\_ If more than one detainee, take a picture of all the detainees together with the cache.
- \_\_\_\_\_ Take close ups of the weapons, grenades, det cords, RPGs, ammunition, etc...
- \_\_\_\_\_ Take a photo of the detainee's house and where the weapons cache was located in relation to the house. (*Note: This photo is used to establish distance from the home and that the detainee owns the property, i.e., the detainee's house needs to be in the background*].
- \_\_\_\_\_ If the cache is located in the detainee's courtyard, take a picture of the courtyard wall. (*Note: this is used to show the property is not easily accessed.*)
- \_\_\_\_\_ Take a picture of the courtyard. (*Note: This is used to show the layout of the property.*)
- \_\_\_\_\_ Take a photo of the family members in front of the house. (*Note: this is used in case the detainee denies ownership of the house.*)
- \_\_\_\_\_ List all weapons and contraband found on the appropriate forms, i.e., the evidence/property inventory form, witness statements, and apprehension form.
- \_\_\_\_\_ The witness statements should state how many photographs were taken and who took them.
- \_\_\_\_\_ Remember to include the photographs in the file.  
**(Example pictures are found in Appendix C, page C-3)**

## WEAPONS INSIDE VEHICLES

- \_\_\_ Take photos of the weapons inside the vehicle before removing them.
- \_\_\_ Take a photo of the entire vehicle.
- \_\_\_ Take a photo of the license plate of the vehicle.
- \_\_\_ Take a photo of the weapons, vehicle and detainees together. (*Note: this is the money shot and is a must!.*)
- \_\_\_ Take close-ups of all weapons and contraband found. If contraband is in a container, make sure it is open and take photographs of what is inside.
- \_\_\_ Take a photo of the area showing where the car was stopped.
- \_\_\_ Take a close up of the car registration.
- \_\_\_ Take a close up of the vehicle's identification number (VIN). This could be under the driver's side windshield or inside the door panel.
- \_\_\_ Remember to identify the driver and passengers in your witness statements.
- \_\_\_ Remember to seize the car registration and their ID cards. This is used to prove the ownership of the vehicle and is a must. Take close up photographs of these items in case they are lost.
- \_\_\_ List all weapons and contraband found on the appropriate forms, i.e., the evidence/property inventory form, witness statements and apprehension form.
- \_\_\_ The witness statements should state how many photographs were taken and who took them.
- \_\_\_ Remember to include the photographs in the file.  
**(Example pictures are found in Appendix C, page C-4)**

## VBIED and IED INVOLVING VEHICLES

- \_\_\_ Take several photographs showing the damage to the vehicle.
- \_\_\_ Take a photograph showing damage to the road.
- \_\_\_ Photograph the entire vehicle, including license plate, registration and VIN (**If possible**).
- \_\_\_ Take several photographs of the aiming points, if any were used by the detainees.
- \_\_\_ Take a photograph of the aiming point showing the damaged vehicle in the background. (*Note: this is used to show distance.*)
- \_\_\_ Take a photograph of where the detainees were captured in relation to the aiming point. (*Note: this is used to show distance.*)
- \_\_\_ Take a photograph of where the detainee was captured in relation to the damaged vehicle. (*Note: this is also used to show distance.*)
- \_\_\_ Take a photograph of where the detainee(s) were first observed by CF after the detonation. (*Note: this is used to distance and view point of the IED placement.*)
- \_\_\_ Take a photograph of the detonation device, if recovered.
- \_\_\_ Take a photograph of the detonation device and the detainee(s), if the device is recovered.
- \_\_\_ Conduct explosive testing on all suspects and record findings. Put finding on all sworn documents.
- \_\_\_ Take photographs of the explosive testing conducted on the detainee(s).
- \_\_\_ The witness statements should state how many photographs were taken and who took them.
- \_\_\_ Remember to include the photographs in the file.  
**(Example pictures are found in Appendix C, page C-5)**

## **VBIED AND IED WHICH RESULT IN INJURIES AND/OR DEATH TO COALITION FORCES**

\_\_\_ **Use the checklist for VBIEDs and IEDs involving vehicles along with the steps outlined below.**

- \_\_\_ Photograph all injuries CF personnel sustain.
- \_\_\_ Include medical records and/or letters from the hospital on all injuries sustained.
- \_\_\_ Photograph wounded CF personnel and responding medical personnel.
- \_\_\_ If there are KIA, a copy of the Death Certificate needs to be filed for each person killed, including CF casualties.

**(Example pictures are found in Appendix C, page C-5)**

### **UNEXPLODED VBIED OR IED**

**(NOTE: ONLY TAKE PICTURES IF IT IS SAFELY POSSIBLE OR SEE IF EOD CAN ASSIST IN TAKING PICTURES, IF NOT DON'T WORRY ABOUT TAKING PICTURES. ABOVE ALL SAFETY FIRST!!!)**

- \_\_\_ Take several photographs showing the IED.
- \_\_\_ Take a photo showing the IED and where it is located/placed in relation to the road.
- \_\_\_ Take several photographs of the aiming points used by the detainees.
- \_\_\_ Take a photograph of the aiming point showing the IED site in the background. (*Note: this is used to show distance.*)
- \_\_\_ Take a photograph of where the detainees were captured in relation to the aiming point. (*Note: this is used to show distance.*)
- \_\_\_ Take a photograph of where the detainee was captured in relation to the IED site. (*Note: this is also used to show distance.*)
- \_\_\_ Take a photograph of where the detainee(s) were first observed by CF after the IED was discovered. (*Note: this is used to distance and view point of the IED placement.*)
- \_\_\_ Take a photograph of the detonation device, if recovered.
- \_\_\_ Take a photograph of the detonation device and the detainee(s), if the device is recovered.
- \_\_\_ Conduct explosive testing on all suspects and record findings. Put findings on all sworn documents.
- \_\_\_ Take photographs of the explosive testing that was conducted on the detainee(s).
- \_\_\_ The witness statements should state how many photographs were taken and who took them.
- \_\_\_ Remember to include the photographs in the file.

**(Example pictures are found in Appendix C, page C-6)**

### **DRIVE BY SHOOTINGS**

- \_\_\_ Annotate dates, time and location in photographs.
- \_\_\_ Photograph from direction of travel and/or aiming direction. This will show "line of sight".
- \_\_\_ Photograph location of where shots were coming from.
- \_\_\_ Photograph any damage.
- \_\_\_ Photograph all CF injuries.
- \_\_\_ Include medical records and/or letters from the hospital on all injuries sustained.
- \_\_\_ Photograph wounded CF personnel and responding medical personnel.

- \_\_\_ If there are KIA, a copy of the Death Certificate needs to be filed for each person killed.
  - \_\_\_ Photograph location of the CF personnel when the incident occurred.
  - \_\_\_ Photograph the location where the detainees were captured.
  - \_\_\_ Photograph the vehicle, to include license plate, registration and VIN.
  - \_\_\_ Photograph all detainees and occupants if detainees were using a vehicle.
  - \_\_\_ Photograph and seize all IDs, visas and passports. Make copies in case any items are lost.
  - \_\_\_ Remember to put all photographs in the file.
- (Example pictures are found in Appendix C, page C-7)**

### **ATTACKS AND ASSAULTS AGAINST CF PERSONNEL**

- \_\_\_ Photograph the location where the attacks and/or assaults took place. These photographs should also include any damage to vehicles or property.
  - \_\_\_ Photograph all weapons and contraband, to include close-up photos of the model and serial numbers, if applicable.
  - \_\_\_ Photograph all detainees with weapons and contraband seized.
  - \_\_\_ Photograph shell casings.
  - \_\_\_ Photograph all injuries CF personnel sustained.
  - \_\_\_ Include medical records and/or letters from the hospital on all injuries sustained.
  - \_\_\_ Photograph wounded CF personnel and responding medical personnel.
  - \_\_\_ If there are KIA, a copy of the Death Certificate needs to be filed for each person killed.
  - \_\_\_ Photograph enemy killed or wounded.
  - \_\_\_ The witness statements should state how many photographs were taken and who took them.
  - \_\_\_ Remember to include the photographs in the file.
- (Example pictures are found in Appendix C, page C-7)**

### **PROPAGANDA**

- \_\_\_ Photograph all computers, cell phones, palm pilots, thumb drives, CDs, DVDs, cameras, video equipment, disks, etc (*Note: This is the money shot and is a must!.*)
  - \_\_\_ Photograph the location where evidence was obtained.
  - \_\_\_ Photograph the detainee with the evidence.
  - \_\_\_ Photograph and seize all detainees' IDs, visas and passports. Make copies in case any items are lost.
  - \_\_\_ Remember to put all photographs in the file.
- (Example pictures are found in Appendix C, page C-8)**

### **KIDNAPPING**

- \_\_\_ Photograph the location where the victims were kidnapped (initial contact).
- \_\_\_ Photograph the interior and exterior of the location where the victims were held (residence, shed, etc). (*Note: this can confirm the location if videotape was used.*)
- \_\_\_ Photograph all weapons and/or blindfolds, tape, money and any other materials with the detainee.
- \_\_\_ Photograph detainee(s) in front of the residence, shed, etc. where victim was held.
- \_\_\_ Photograph any injuries the victim(s) sustained.
- \_\_\_ Remember to put all photographs in the file.

## ESCAPES

- \_\_\_\_\_ Photograph all escapees and the location where captured. (*Note: If captured in an open area, photograph any landmarks. If in a residence, building, etc., photograph the interior and exterior and identify the point of entry.*)
- \_\_\_\_\_ Photograph all persons who assisted the detainee.
- \_\_\_\_\_ Photograph the vehicle if used in the escape. (*Note: Include the license plate, registration and VIN, if possible.*)
- \_\_\_\_\_ Photograph the structure the detainee escaped from, in other words the confinement facility or vehicle.
- \_\_\_\_\_ Photograph the point of escape. (For example the hole, door, window or gate.)
- \_\_\_\_\_ Remember to put all photographs in the file.

## HARBORING FUGITIVES/THIRD COUNTRY NATIONALS/FOREIGN FIGHTERS

- \_\_\_\_\_ Photograph the location where the detainees were captured. If in a unique hiding place, photograph someone in the hiding place to reference the size. This could be used to inform other units of “new and improved” hiding places.
- \_\_\_\_\_ If a residence, photograph the interior and exterior and the owner. Photograph all rooms to include walls, windows, doors, and ceilings inside and all possible entrances and exits leading to and from the home and/or the surrounding courtyard.
- \_\_\_\_\_ Seize all detainees IDs, visas and passports. Take close up photographs of all IDs, visas and passports. Make copies in case any items are lost.
- \_\_\_\_\_ Photograph the detainees in front of the location where they were captured and with any weapons or contraband they were captured with.
- \_\_\_\_\_ The witness statements should state how many photographs were taken and who took them.
- \_\_\_\_\_ Remember to include the photographs in the file.

## CLOSING REMARKS

- THINK ABOUT HOW LONG IT TAKES TO PLAN AN OPERATION, REHEARSE IT, AND THEN EXECUTE IT.
- THINK ABOUT HOW MUCH TIME IT TAKES TO PROPERLY PUT TOGETHER THE NECESSARY EVIDENCE (TO INCLUDE AS MANY PICTURES AS YOU CAN GET SAFELY).
- THINK ABOUT HOW MUCH TIME IT TAKES TO PLAN AND EXECUTE ANOTHER OPERATION TO GO GET A GUY YOU ALREADY DETAINED ONCE BUT DIDN'T PUT THE EVIDENCE TOGETHER PROPERLY.

# APPENDIX A

## TF 134 RECOMMENDED LIST OF USEFUL ITEMS

- ✓ Digital Camera [Note: make sure the date is right, if the camera has this capability]
- ✓ Evidence Inventory Forms
- ✓ Witness Statements Forms (DA Form 2823.23)
- ✓ Evidence Property Custody Document (DA Form 4137)
- ✓ Gun/Explosive Residue Kits
- ✓ Blind Folds or blackout goggles
- ✓ Flex-cuffs
- ✓ Heavy duty tape
- ✓ Gloves or a piece of cloth [Note: for handling evidence that needs to be finger printed]
- ✓ Sharpie/Black pen
- ✓ Tape measure
- ✓ Paper bags, “Zip-Loc” bags, card board boxes, foot lockers or plastic trash bags [Note: for collecting and storing evidence]

## APPENDIX A-2

### PROPER EVIDENCE HANDLING PROCEDURES

Below are the proper methods, techniques and procedures for handling evidence. If you are unsure of what needs to be done, don't be afraid to ask following types of law enforcement agencies for help: military police, security forces, master of arms (Navy), OSI or CID agents, or your legal office for help if these resources are located at your FOB. We all want to ensure that the detainees stay behind bars if they are a security threat.

- The chain of custody begins when an item of evidence is collected by any Coalition Forces member. Evidence will no doubt be passed from person to person and even unit to unit during the course of an investigation and subsequent trial. The written, chronological record of transactions of this type is the chain of custody. Each person who takes physical control over evidence must be identified as a part of the evidence chain.
- Correct identification of evidence is accomplished when the Coalition Force member who initially takes custody of the evidence promptly marks and tags the item(s) of evidence.
- Evidence should be inscribed with the initials of the collector and military date and time. Place the marking so as not to:
  - Destroy any latent (hidden) characteristics
  - Reduce the function of the object
  - Devalue it

Common sense and an understanding of how the evidence relates to the commission of the crime will dictate where and how to mark the evidence.

- When an item of evidence cannot be marked without marring or destroying evidentiary characteristics, it is placed in a suitable container, sealed, and marked for identification. An evidence tag further serves to identify the evidence. Remember to put the detainee's name, capture tag number, date of capture, capturing unit, and other relevant information on the evidence tag. It is no good, if it can't be matched to the detainee at a later date.
- Evidence should be packaged and wrapped to minimize friction and to prevent shifting, breaking, leaking, or contact with other evidence.
- Items such as ammunition, bullets, cartridge cases, tablets, and capsules, which are particularly susceptible to breaking, marring, or other destructive changes, should be packed in cotton or soft paper.
- Items that contain stains, such as clothing with stains of blood or other body fluids, should not be placed in airtight plastic containers. "Sweating" and moisture accumulation may occur within such containers, contaminating the evidence. Such items must be dry before packaging. This caution also applies to fingerprint evidence.

## APPENDIX A-2

- When evidence is to be examined for fingerprints, each item of evidence should be packed in a manner that prevents damage to the fingerprints. This is accomplished by fastening the object in the container so that it will not shift and so that other objects will not come in contact with the areas of the object suspected of containing fingerprints.
- With the exception of explosives (oils and gasoline), liquid evidence should be packed in sterile, all-glass bottles or other containers and sealed with wax or other suitable materials.
- In general, small, solid items such as fibers, hairs, paint scrapings, powder, powder patterns, and threads should be placed on separate pieces of plain paper. Fold each piece of paper and pack it in a pill or powder box, paper container, or druggist fold. Seal the container with adhesive tape, wax, or other suitable material.
- Documents, exemplars, standards, strings, twine, and rope should be placed in an inner cellophane envelope and an outer manila envelope. Cellophane is not suitable for packing any item that will rust or corrode.
- Packages containing items of evidence such as acids, ammunition, guns, medicines, chemicals, drugs, and paints, which require careful or selective handling while in transit, should be labeled Corrosive, Fragile, Keep Away From Fire, or Keep Cool, as appropriate.



# APPENDIX B

## SWORN STATEMENT

SWORN STATEMENT			
For use of this form, see AR 190-45; the proponent agency is PMG.			
PRIVACY ACT STATEMENT			
AUTHORITY:	Title 10 USC Section 301; Title 5 USC Section 2951; E.O. 9397 dated November 22, 1943 (SSN).		
PRINCIPAL:	To provide commanders and law enforcement officials with means by which information may be accurately identified.		
ROUTINE USES:	Your social security number is used as an additional/alternate means of identification to facilitate filing and retrieval.		
DISCLOSURE:	Disclosure of your social security number is voluntary.		
1. LOCATION	2. DATE (YYYYMMDD)	3. TIME	4. FILE NUMBER
5. LAST NAME, FIRST NAME, MIDDLE NAME	6. SSN	7. GRADE/STATUS	
8. ORGANIZATION OR ADDRESS			
9. I, _____, WANT TO MAKE THE FOLLOWING STATEMENT UNDER OATH:			
1. Name of detainee(s):			
2. Date/Time the mission started:			
3. Date/Time of significant events during the mission (arrival at target, unusual activity, engagement, etc.):			
4. Date/Time the Detainee was taken into custody:			
5. Grid Coordinates of Location where the Detainee was picked up:			
6. The name of the region/town where the Detainee was picked up:			
7. Nearby landmarks or buildings:			
8. If the Detainee was picked up inside a building, where in the building was he at the time he was taken into custody:			
9. Draw a diagram of the location (use an attached piece of paper if necessary, show the building searched, locations of any evidence seized, any nearby landmarks or critical locations & where the detainee was at the time he/she was taken into custody):			
10. Why were you at that location?			
11. Were you looking for anyone/thing specific?			
12. Besides the Detainee, who else was present?			
13. What caused you to search these people or premises?			
14. What evidence was seized?			
15. Who are the owners of the evidence? How do you know?			
16. If there are weapons, how many? What kind? Where were they found? Have they been recently used? How do you know?			
10. EXHIBIT	11. INITIALS OF PERSON MAKING STATEMENT		PAGE 1 OF _____ PAGES
ADDITIONAL PAGES MUST CONTAIN THE HEADING "STATEMENT _____ TAKEN AT _____ DATED _____"			
THE BOTTOM OF EACH ADDITIONAL PAGE MUST BEAR THE INITIALS OF THE PERSON MAKING THE STATEMENT, AND PAGE NUMBER MUST BE BE INDICATED.			

# COALITION PROVISIONAL AUTHORITY FORCES APPREHENSION FORM

## COALITION PROVISIONAL AUTHORITY FORCES APPREHENSION FORM YELLOW FIELDS MUST BE FILLED IN, IF APPLICABLE, UPON APPREHENSION

<input type="checkbox"/> <b>Offense against Civilian(s) [check one] If "Other" then describe: _____ "X" ALL THAT APPLY</b>			
<input type="checkbox"/> Arson (I.P.C. 342)	<input type="checkbox"/> Burglary or Housebreaking (I.P.C. 426)	<input type="checkbox"/> Solicitation of Fornication/Prostitution (I.P.C. 399)	<input type="checkbox"/> Extortion/Communicating Threats (I.P.C. 430)
<input type="checkbox"/> Rape/Indecent/Sexual Assaults/Acts (I.P.C. 393-98, 402)	<input type="checkbox"/> Theft (I.P.C. 436)	<input checked="" type="checkbox"/> Murder (I.P.C. 405)	<input type="checkbox"/> Destruction of Property (I.P.C. 477)
<input type="checkbox"/> Aggravated Assault/Assault With Intent To Kill (I.P.C. 410)	<input type="checkbox"/> Obstructing a Public Highway/Place (I.P.C. 487)	<input type="checkbox"/> Maiming (I.P.C. 412)	<input type="checkbox"/> Discharging Firearm/ Explosive in City/Town/Village (I.P.C. 495)
<input type="checkbox"/> Simple Assault (I.P.C. 415)	<input type="checkbox"/> Riot or Breach of Peace (I.P.C. 495(3))	<input checked="" type="checkbox"/> Kidnapping (I.P.C. 421)	<input type="checkbox"/> Other
<input type="checkbox"/> <b>Offense against Coalition Forces [check one] If "Other" then describe: _____ "X" ALL THAT APPLY</b>			
<input type="checkbox"/> Violation of Curfew	<input type="checkbox"/> Trespass on Military Installation or Facility	<input type="checkbox"/> Illegal Possession of Weapon	<input type="checkbox"/> Photographing/Surveilling Military Installation or Facility
<input checked="" type="checkbox"/> Assault/Attack on Coalition Forces	<input type="checkbox"/> Obstructing Performance of Military Mission	<input type="checkbox"/> Theft of Coalition Force Property	<input type="checkbox"/> Other
Apprehending Unit: <b>INCLUDE MSC</b>		Location Grid:	
Date of Incident: (D/M/Y) / / to / /	Time of Incident: hrs to hrs	Date of Report: (D/M/Y) / /	Time of Report: hrs
Detainee # _____		Key Connected Person: <input type="checkbox"/> Victim <input type="checkbox"/> Witness	
Last Name: _____		Last Name: _____	
First Name: _____ Given Name: _____		First Name: _____ Given Name: _____	
Hair Color: _____	Scars/Tattoos/Deformities: _____	Hair Color: _____	Scars/Tattoos/Deformities: _____
Eye-Color: _____	Weight: lb Height: in	Eye-Color: _____	Weight: lb Height: in
Address: _____		Address: _____	
Place of Birth: _____		Place of Birth: _____	
Ethn/Tribe/ Sect:	Sex: <input type="checkbox"/> M <input type="checkbox"/> F	Phone#: DOB D/M/Y: _____	<input type="checkbox"/> Mobile <input type="checkbox"/> Regular
<input type="checkbox"/> Passport <input type="checkbox"/> Dr. license <input type="checkbox"/> Other (specify)	<input type="checkbox"/> Passport <input type="checkbox"/> Dr. license <input type="checkbox"/> Other (specify)		
Document #:		Document #:	
Total Number of Persons Involved _____ (list names/identifying info on reverse under "Additional Helpful Information")			
<input type="checkbox"/> Vehicle Information Vehicle Number _____ of _____ Vehicle(s)			
Make: _____	Color: _____	License No.: _____	Owner: _____
Model: _____	Type: _____	Plate No.: _____	Number of People in Vehicle: _____
Year: _____	Names of People in Vehicle: _____		
Contraband/Weapons in Vehicle:			
<input type="checkbox"/> Property/Contraband <input type="checkbox"/> Weapon		Photo Taken of Suspect with Weapon/Contraband: Yes/ No	
Type: _____	Model: _____	Color/Caliber: _____	
Serial No.: _____	Quantity: _____	Make: _____	Receipt Provided to Owner: Yes/ No
Other Details: _____		Where Found: _____	Owner: _____
Name of Assisting Interpreter: _____		Email, Phone, or Contact Info: _____	
Detaining Soldier's Name (Print): _____		Supervising Officer's Name (Print): _____	
Last, First MI _____		Last, First MI _____	
Signature: _____		Signature: _____	
Email: john.doe@domain.com /Make legible		Email: jane.doe@domain.net /Make legible	
Unit Phone: Comm or DSN Date: / /		Unit Phone: Comm or DSN Date: / /	

COALITION PROVISIONAL AUTHORITY FORCES APPREHENSION FORM  
(CONT)

COALITION PROVISIONAL AUTHORITY FORCES APPREHENSION FORM

Why was this person detained? \_\_\_\_\_

Who witnessed this person being detained or the reason for detention? Give names, contact numbers, addresses.

PUT POC INFORMATION FOR ALL WITNESSES. WE NEED THIS TO MAKE CONTACT FOR TESTIFYING.

How was this person traveling (car, bus, on foot)? \_\_\_\_\_

Who was with this person? \_\_\_\_\_

What weapons was this person carrying? \_\_\_\_\_

What contraband was this person carrying? \_\_\_\_\_

What other weapons were seized? \_\_\_\_\_

What other information did you get from this person? \_\_\_\_\_

Additional Helpful Information: **WHEN ARE YOU REDEPLOYING?** \_\_\_\_\_



# EVIDENCE INVENTORY FORM



DEPARTMENT OF DEFENSE  
COMMANDING GENERAL TASK FORCE 134  
MULTI-NATIONAL FORCE - IRAQ

## EVIDENCE INVENTORY FORM

On (في) \_\_\_\_\_ [DATE] (التاريخ), at (حوالي) \_\_\_\_\_ [TIME] (الوقت), at (في) \_\_\_\_\_ [CITY]  
LOCATION] (المنطقة بالمدينة) \_\_\_\_\_ [NAME] (الاسم) was found with the following items  
(include the amt in blanks & description where items found to the right of item) (أعطي الكمية) حيث وجدت في حيازته المواد التالية:

_____ AK-47's	عدد الكلاشنكوف
_____ AK-47 AMMO	عدد طلقات الكلاشنكوف
_____ AK-47 MAGAZINES	عدد مخازن الكلاشنكوف
_____ GRENADES	عدد القنابل اليدوية
_____ MACHINE GUNS	عدد الرشاشات
_____ MACHINE GUN AMMO	عدد طلقات الرشاشة
_____ RPG's	عدد صواريخ الأرب بي جي
_____ RPG LAUNCHERS	عدد قننات الأرب بي جي
_____ MORTAR ROUNDS	عدد قذائف الهاون
_____ MORTAR TUBES	عدد الأنابيب الخاصة بمدفع الهاون
_____ EXPLOSIVES (TYPE _____)	عدد المتفجرات (النوع _____)
_____ IED DETONATORS	عدد العبوات الناسفة
_____ IED TIMERS	عدد المؤقتات الخاصة بتفجير العبوة الناسفة
_____ IED MAKING MATERIAL	مواد تصنيع العبوة الناسفة
_____ PROPAGANDA (TYPE _____)	عدد المنشورات (النوع _____)
_____ OTHER _____	أشياء أخرى
_____ OTHER _____	أشياء أخرى

WITNESS NAME (أسم الشاهد) \_\_\_\_\_ WITNESS SIGNATURE (أمضاء الشاهد) \_\_\_\_\_

WITNESS NAME (أسم الشاهد) \_\_\_\_\_ WITNESS SIGNATURE (أمضاء الشاهد) \_\_\_\_\_

WITNESS' UNIT (include company, battalion, brigade, div): \_\_\_\_\_

DETAINEE STATEMENT (use back of page if necessary) (إفادة المتهم أو المدعى عليه): \_\_\_\_\_

\_\_\_\_\_ (أمضاء المتهم أو المدعى عليه) DETAINEE SIGNATURE

**\*\*DO NOT REMOVE THIS DOCUMENT FROM THE DETAINEE'S FILE\*\***

THIS DOCUMENT IS NECESSARY FOR PROSECUTION AT THE CENTRAL CRIMINAL COURT OF IRAQ



# DIAGRAMS

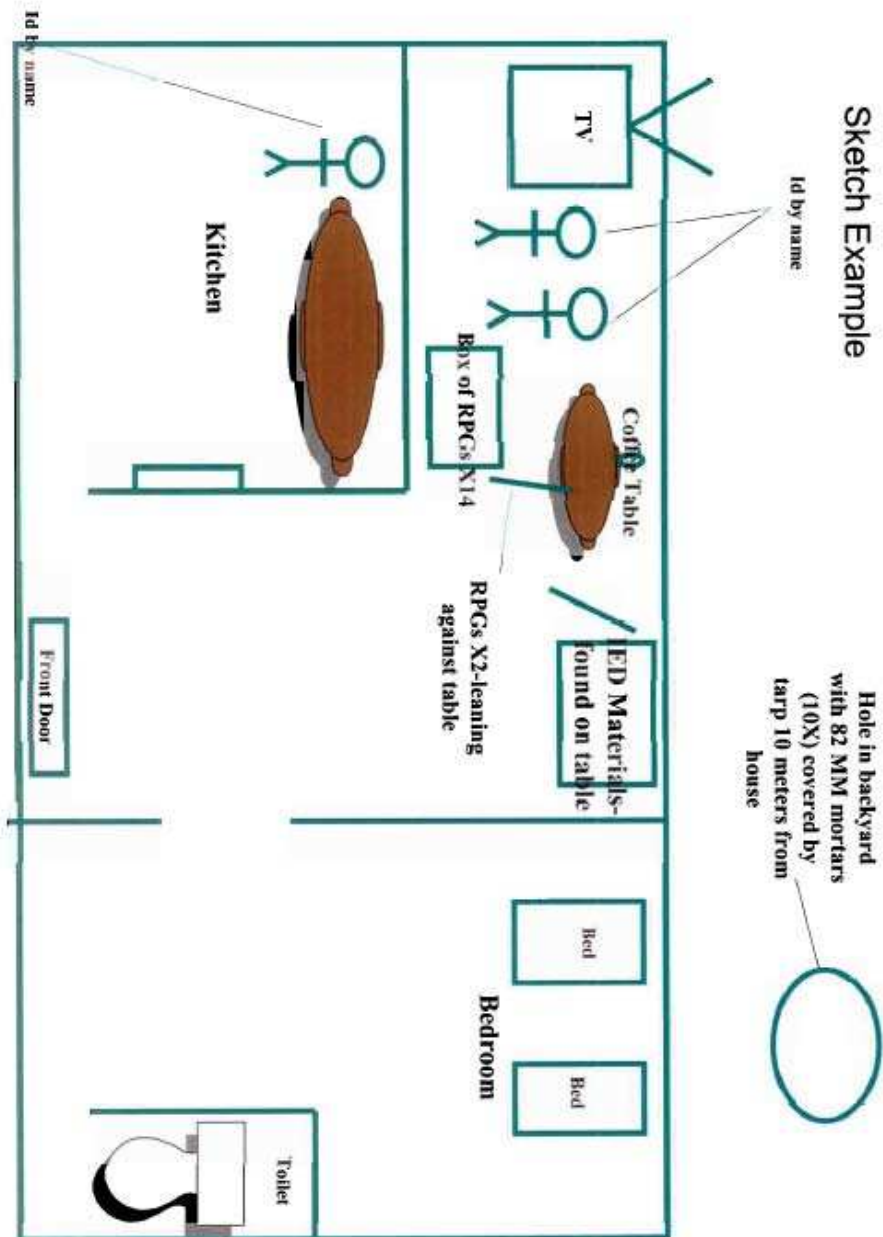

**DIAGRAMS  
(CONT)**

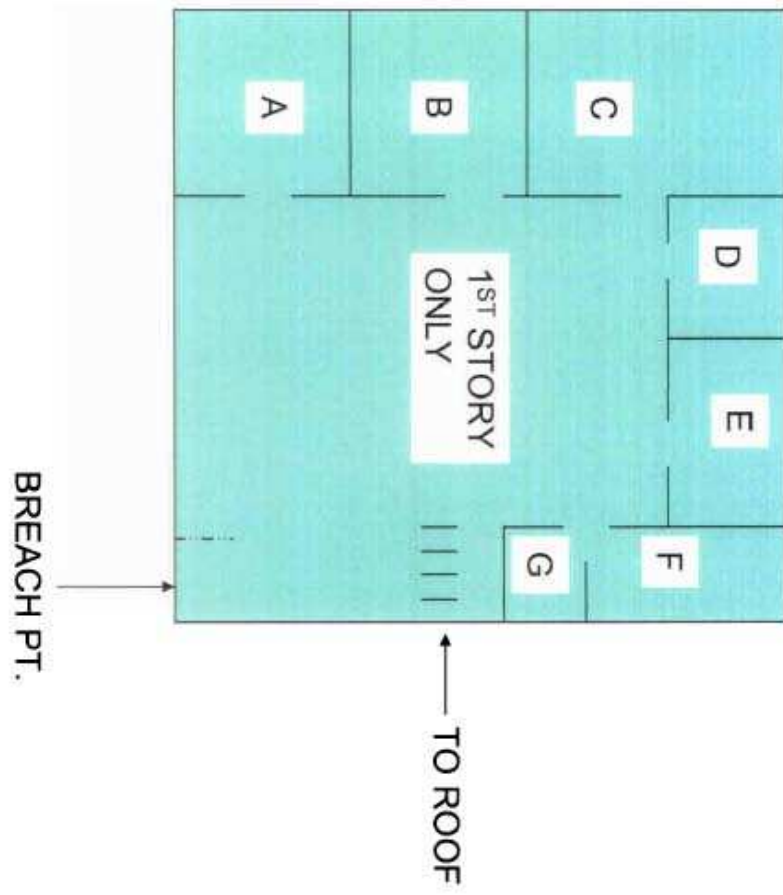

# APPENDIX C

## WEAPONS CACHE IN RESIDENCE



These two pictures show the detainees' residence and show where the raid occurred.



Shows how the items were found in house. Depicts the detainee with weapons.



Depicts the detainee with the weapons (a must!).

A close up of the weapons found with the detainee.



# APPENDIX C

## WEAPONS CACHE IN RESIDENCE



These two pictures show where the weapons were found in the home.



Shows where the detainee was captured.

Photograph what is inside the box.

## WEAPONS CACHE OUTSIDE



Shows house in relation to cache.



Depicts everything found.



Depicts all of the ordinance found.



Good close up and the lid is open.



Detainee pictured with contraband.



Detainee pictured with weapons.  
(A MUST!)



## WEAPONS INSIDE VEHICLES



These two photographs show what is contained in the boxes.



These four pictures show where the concealed weapon was found hidden in the vehicle.



Shows license plate.

Shows the detainees, vehicle and the explosives.



## VBIED & IED INVOLVING VEHICLES



Shows the whole vehicle.



Shows the explosives.



A close up of the explosives.



Depicts the detainee with VBIED.



Shows the VBIED.



Shows the scene.



Shows where the explosion occurred.



A close up.



## UNEXPLODED VBIED OR IED



Shows the license plates.



Shows the detonator.



Shows the IED.



Shows EOD on scene.



Shows the wiring of the VBIED.



Depicts the VBIED and the scene.



## DRIVE BY SHOOTING & ATTACK ON COALITION FORCES



These pictures show the damage done to the Coalition Forces vehicle and prove that the attack actually occurred.



# PROPAGANDA



Only thing wrong with this picture is that one **can not** see the detainees' faces.

The rest of the pictures show that the detainees' actually possessed propaganda.





## DO'S & DON'TS

**DO**



Can see faces.

**DO NOT**



Can not see the faces.



Can see inside the ammo boxes.



Can't see inside the ammo boxes



Can see inside the crate.



Make the photograph look professional.



Both pictures show how the weapons were found, but would be better if the detainee was also in the picture.



## DO'S & DON'TS

**DO**

**DO NOT**



Take a photo of the objective.

Don't take a scrap book photo.



Take photo of how the stuff was found.

Again, no posing with the ordinance found.



Shows how it was found.

Shows what was found in the box from the picture to the left (this is a do).

## NOTES